

会场情况介绍 Venue Introduction

主会场简介 Main Venue Introduction

主会场搭建18m*4.5m曲面LED屏

The main venue is equipped with an 18m*4.5m curved LED screen;

舞台尺寸约4m*18m*0.6m(除LED屏占用部分)

The stage size is about 4m*18m*0.6m (excluding the part occupied by the LED screen);

台上设计搭建立体logo及演讲台，整体配备了完善的灯光音响舞美设备。

The stage is built with a three-dimensional logo and a podium and is equipped with lighting, sound, and stage equipment.



主舞台搭建特写效果图

Close-up Rendering of the Main Stage Construction



主会场舞美搭建全景效果图

Panoramic Rendering of the Main Stage Construction

会场情况介绍 Venue Introduction

展览区简介 Exhibition Area Introduction

展览区位于天府厅（1厅），尺寸长28m*宽17m*高7m，可容纳17个统一设计展位，序厅搭建8个展位，共可搭建25个展位。

The exhibition area is located in Tianfu Hall (Hall 1), with dimensions of 28m long, 17m wide, and 7m high, and can accommodate 17 booths of uniform design, the lobby can accommodate 8 booths, and a total of 25 booths can be constructed;

正反两面墙可利用会场现有吊点，悬挂广告条幅（条幅设计尺寸：1m*3m）

The front and back walls can use the existing hanging points of the venue to hang advertising banners (size: 1m*3m)



A厅搭建效果图
Rendering of Hall A



展位说明效果图
Rendering of Booth Design

会场情况介绍 Venue Introduction

天府厅整体简介 Tianfu Hall Overview

茶歇位于序厅过道及A厅中间空余位置

The coffee break area is located in the space between the lobby hallway and Hall A

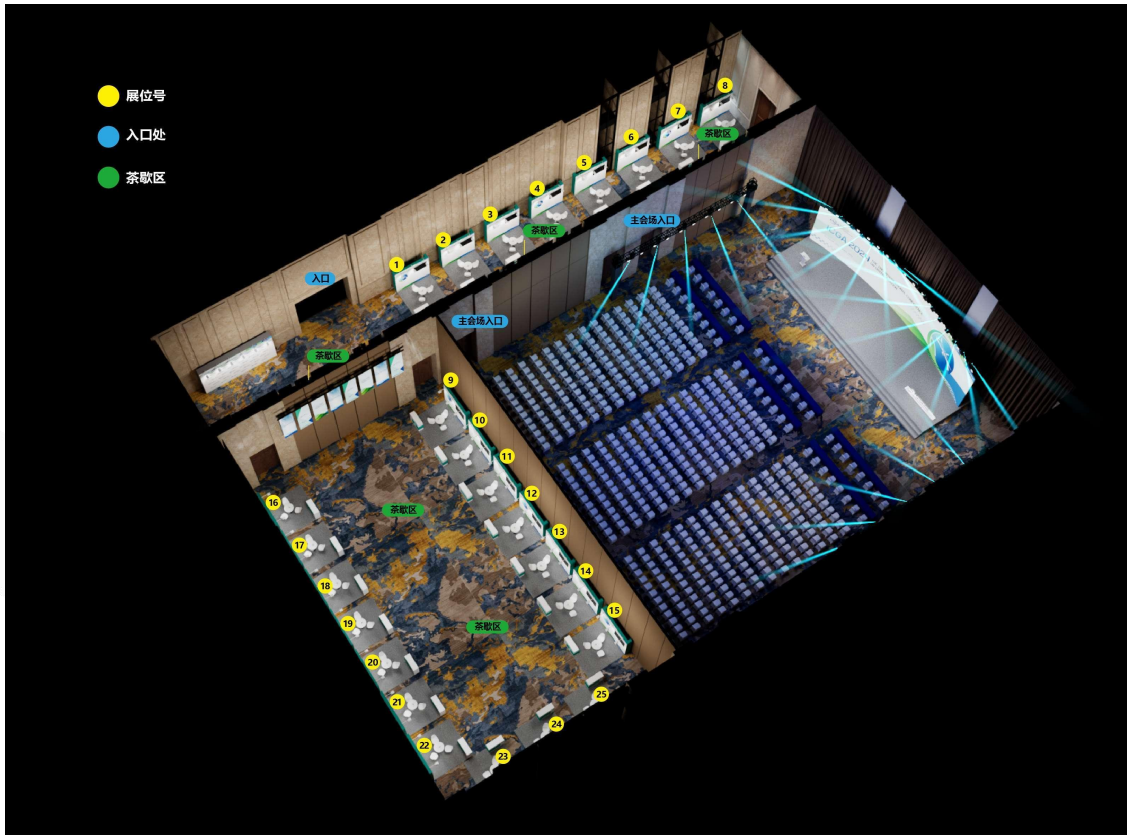

天府厅整体搭建俯视图
Overview of the Overall Construction of Tianfu Hall



序厅搭建效果图
Rendering of the Lobby Construction